

Lumenis Holmium Laser Fiber Line

Performance, Reliability and Flexibility



Performance & Reliability

Lumenis fibers are specifically tailored and validated for optimal performance with the Lumenis family of lasers:

- Customized optical connection.
- Exact match of the optical specifications such as spot size, focal point location and focus angle.

Risks of using non-lumenis fibers

The optical incompatibility of non-Lumenis fibers could result in energy loss due to leakage and decreased energy transmission, possibly affecting safety, clinical effectiveness, and overall laser system quality in the following ways:

- Reduced energy transmission may result in delivering less energy to tissue than the laser screen indicates, resulting in reduced and unexpected tissue or lithotripsy effect.
- Leaking energy may cause damage to the laser debris shield, delivery device, scope, or laser system. Leaking energy may burn patient and/or operator.
- Leaking energy may cause premature fiber wear, resulting in suboptimal performance or fewer than expected number of uses for reusable fibers.

Smart Fibers

Lumenis' fiber line also includes integrated SIS (Smart Identification System) technology which enables system detection of which fiber has been connected. These reusable and single-use fibers are custom designed to work with Lumenis laser systems.

SIS Fiber

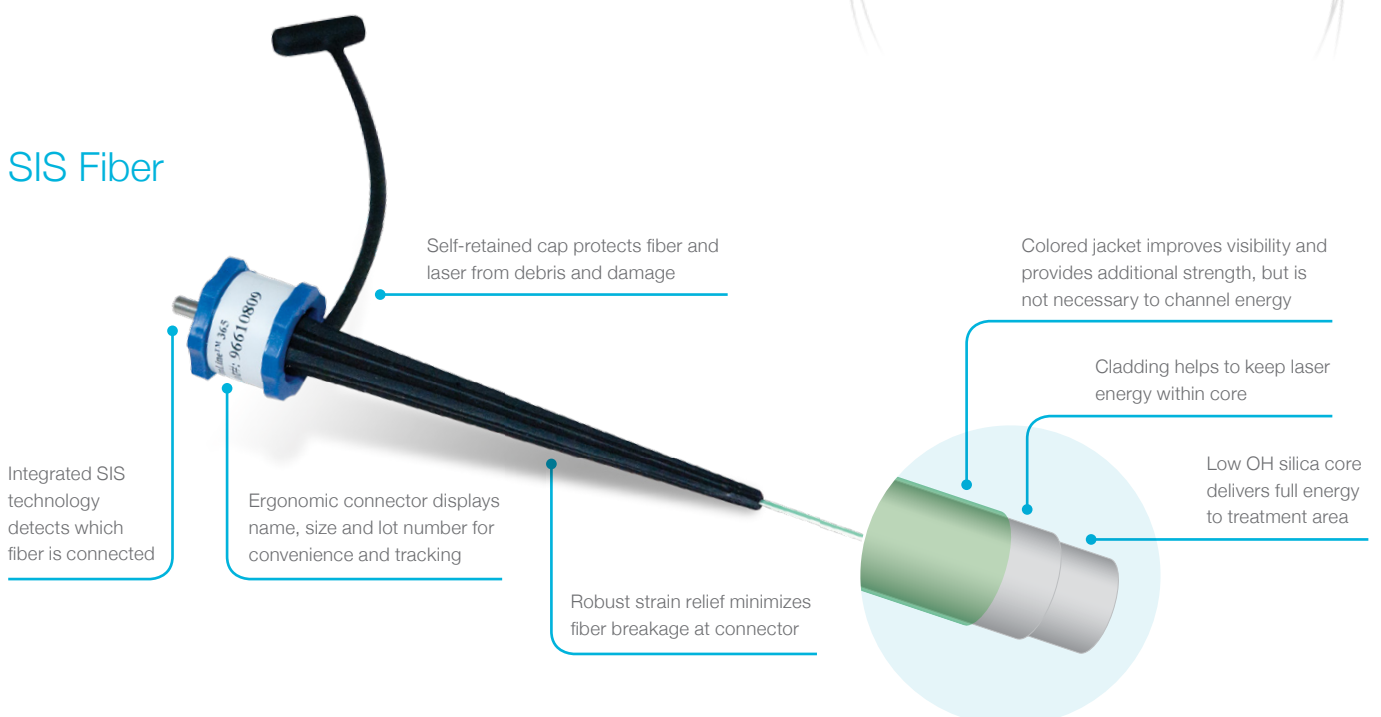

Variety of Delivery Solutions

SlimLine™ family of fibers

Designed for durability, flexibility and versatility in urological procedures.

- Available in 272, 365, 550 and 1000 micron.
- SlimLine™ 200 D/F/L the Smooth Tip fiber: Is designed for flexible ureteroscopy procedures. Enabling smooth initial fiber insertion through a deflected scope.
- Xpeeda™ D/S/L side-fire fiber: A tailored solution for BPH vaporization delivers maximal energy directly to the tissue while working in full contact.

SlimLine SIS Endo

- Suitable for orthopedic, neurology, spine surgery and pulmonary procedures
- Single-use, end-fire fibers
- Available in 272, 265 and 550 microns

SlimLine SIS GI

- Designated for ablation, vaporization, incision, excision, resection, coagulation and homeostasis in GI indications such as biliary/bile duct calculi, benign and malignant neoplasm.
- Single-use, end-fire fibers
- 365 micron
- Specialized fiber tip allows for easy passage through a cholangioscope.

Risk Information:

The use of the Lumenis Pulse™ and VersaPulse® PowerSuite™ laser systems and delivery devices in urology is contraindicated for patients who are unable to receive endoscopic treatments or are intolerant to prolonged anesthesia, as well as for resection or excision of large vascularized organs. Holmium lasers are intended solely for use by physicians trained in the use of the Ho:YAG (2.1 µm) wavelength.

Incorrect treatment settings can cause serious tissue damage. The laser should be used only on tissues that are fully observable. See the system's user manual for a complete list of contraindications and risks.

Fiber Specifications

	SlimLine 200 D/F/L	SlimLine EZ 200	SlimLine EZ 365	SlimLine EZ 550	SlimLine 200	SlimLine 365	SlimLine 550	SlimLine 1000	Xpeeda D/S/L
Maximal input energy (J)	2	1.5	6	6	1.5	6	6	6	2
Maximal repetition rate (Hz)	80	40	80	80	40	80	80	80	60
Maximal input power (W)	60	45	120	120	45	120	120	120	120
Core diameter (µm)	230	272	365	550	272	365	550	955	550
Maximal outer diameter (µm)	390	450	580	780	450	580	780	1450	2500
Tip outer diameter (µm)	450 (With Ball Tip)	450	580	780	450	580	780	1450	2500
Minimal fiber bending radius at maximum power (mm)	6mm	12mm	14mm	20mm	12mm	14mm	20mm	24mm	NA
Single Use (SU) or Multiple-Use (MU)	SU	SU	SU	SU	MU	MU	MU	MU	SU

Accessories

Sterilization Tray

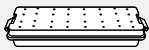

Scissors

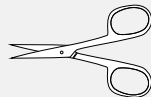

Fiber Strippers

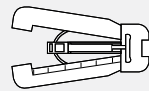

Inspection Scope

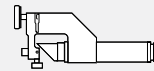

Cleaving Tool

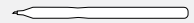

 Lumenis Ltd.
Yokneam Industrial Park
6 Hakidma Street P.O.B. 240
Yokneam 2069204, Israel
Tel: +972-4-959-9000

 Lumenis (Germany) GmbH
Heinrich-Hertz-Str.3 D-63303
Dreieich-Dreieichenhain
GERMANY
Tel: +49 (0) 6103 8335 0

AMERICAS
San Jose, CA, USA
T +1 408 764 3000
+1 877 586 3647
F +1 408 764 3999

ASIA / PACIFIC
Beijing, China
T + 86 10 5737 6677
Gurgaon, India
T + 91 124 422 07 95
Kowloon, Hong Kong
T + 852 217 428 00
F + 852 272 251 51

JAPAN
Tokyo, Japan
T +81 3 4431 8300
F +81 3 4431 8301

EMEA
Dreieich Dreieichenhain,
Germany
T +49 6103 8335 0
F +49 6103 8335 300
Roma (RM), Italy
T +39 06 90 75 230
F +39 06 90 75 269
Hertfordshire, UK
T +44 20 8736 4110
F +44 20 8736 4119

