

The complete guide to

Sonopet **iQ**



Leading the way to **better surgical experiences**

Conceived from international collaboration between surgeons and built around the user experience, the Sonopet iQ takes simplicity and reliability to an even higher level, leading to consistently excellent O.R. surgical experiences. Experience semi-autonomous functionality and unparalleled customization that empowers any O.R. team, any time, day or night.

Unparalleled customization

One-step retrieval of surgeon profile

RFID automatic optimization

instantly changes settings based on connected tip or user profile.

Take control

Choose from three foot pedals and a hand controller for remote control from sterile or non-sterile field.

Simpler setup; instant readiness

One-step non-sequential connections



Greater irrigation control

Auto prime
Increased visibility
Designed for controlled suction pinch valve
One-click cassette
Integrated into end of handpiece

One-step connections

For irrigation, suction, tubing and sleeve

Enhanced guidance

Onscreen setup and tutorials
Alignment dots and color-changing ports provide connection feedback.
Large touchscreen

Handpiece refinements

Designed for power, performance and reliability

Capital

Sonopet iQ Ultrasonic Aspirator Console

5500-050-000

(includes power cord, irrigation pole and hand controller)



Sonopet iQ Hand Controller

5500-402-000



Sonopet iQ Advanced Foot Pedal - Wired

5500-007-000



Irrigation Pole

5100-050-028

Cleaning Wire

5450-800-276

U.S. Power Cord

0996-051-011SP

Sonopet iQ Universal Angled Handpiece

5500-255-000



Sonopet Torque Wrench, 7mm

5450-800-039



Sonopet iQ Advanced Foot Pedal - Wireless

5500-008-000

(includes wireless receiver)



Sonopet Cart

5450-850-410



Sonopet iQ Sterilization Tray

5500-800-278



Sonopet iQ Basic Foot Pedal - Wired

5500-006-000



Sonopet iQ Wireless Receiver

5500-008-300



Disposables

Suction Canister

5450-851-012
12/box



Sonopet iQ Irrigation Suction Cassette

5500-573-000
4/box



Sterile Drape

5500-472-000
4/box



Soft tissue

12cm iQ Micro

5500-25S-309 4/box

L 4.7in (120mm) **OD** 1.6mm **ID** 1.20mm



12cm iQ Standard

5500-25S-307 4/box

L 4.5in (115mm) **OD** 1.92mm **ID** 1.5mm



12cm iQ Large

5500-25S-308 4/box

L 4.7in (112.1mm) **OD** 2.49mm **ID** 2.0mm



20cm iQ Standard

5500-25S-301 4/box

L 8.1in (205mm) **OD** 1.92mm **ID** 1.5mm



12cm iQ Barracuda

5500-25S-310 4/box

L 4.5in (115mm) **OD** 1.92mm **ID** 1.5mm



12cm iQ Serrated Large

5500-25S-316 4/box

L 4.6in (115.7mm) **OD** 2.51mm **ID** 2.0mm



L = Length **OD** = Outer diameter **ID** = Inside diameter

Removal of the frangible sleeve adds 7.5mm to working lengths. On 5500-25B-114 and 5500-25B-107 there are 2 frangible sleeves meaning their working length can be increased by 7.5mm or 15mm. For 5500-25B-110 10cm iQ Broad Knife there is no frangible section on the sleeve.

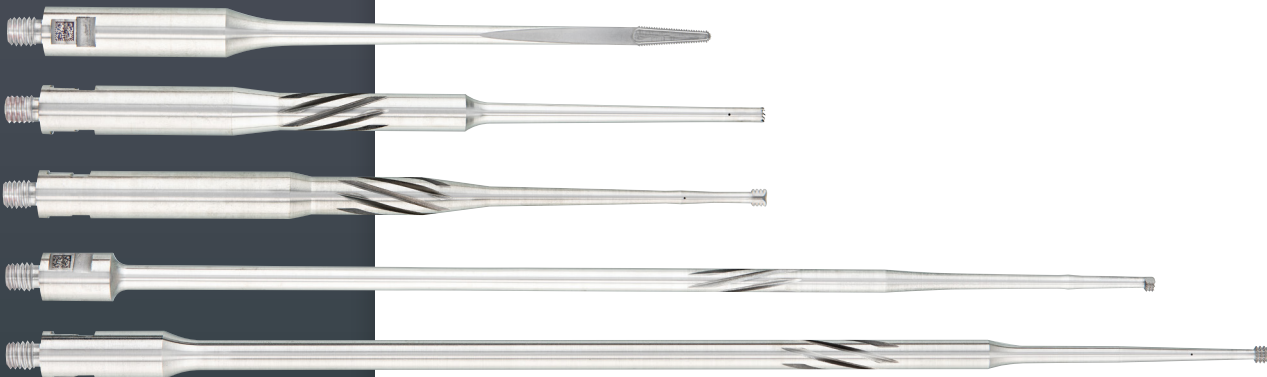

Bone cutting

12cm iQ Micro Claw

5500-25B-315 4/box

L 4.8in (121mm) **CL** 1.6mm **CW** 2mm



12cm iQ Claw

5500-25B-318 4/box

L 4.8in (121mm) **CL** 1.7mm **CW** 2.8mm



12cm iQ 120 Claw

5500-25B-317 4/box

L 4.8in (121mm) **CL** 2.58mm **CW** 3.15mm



12cm iQ Apex 360

5500-25B-312 4/box

L 4.8in (121mm) **CL** 2.58mm **CW** 3.15mm



20cm iQ Apex 360

5500-25B-302 4/box

L 7.9in (200mm) **CL** 2.5mm **CW** 3.15mm



18cm iQ Micro Claw

5500-25B-303 4/box

L 7.2in (182.8mm) **CL** 1.6mm **CW** 2mm



18cm iQ Apex Micro Claw

5500-25B-319 4/box

L 7.2in (182.8mm) **CL** 1.6mm **CW** 2mm



11cm iQ Knife

5500-25B-107 4/box

L 4.2in (106mm) **CL** 11.6mm **CW** 0.83mm



11cm iQ Apex Knife

5500-25B-114 4/box

L 4.2in (106mm) **CL** 12mm **CW** 0.83mm



10cm iQ Broad Knife

5500-25B-110 4/box

L 3.98in (101mm) **CL** 8.2mm **CW** 1.4mm **WL** 25mm



L = Length **CL** = Cutting length **CW** = Cutting width **WL** = Working length

Removal of the frangible sleeve adds 7.5mm to working lengths. On 5500-25B-114 and 5500-25B-107 there are 2 frangible sleeves meaning their working length can be increased by 7.5mm or 15mm. For 5500-25B-110 10cm iQ Broad Knife there is no frangible section on the sleeve.

Configured for **success**

The Sonopet iQ system works hard to support you during procedures, but its setup is routine and easy.

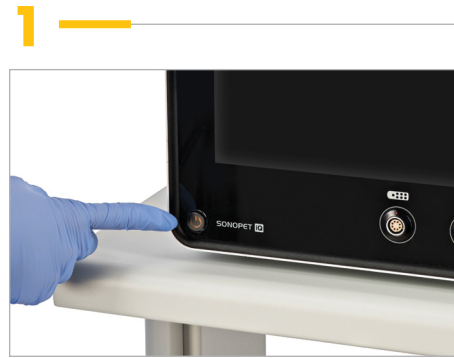

- Position the console so the power cord receptacle can be easily accessed
- Connect the power cord to a hospital-grade power receptacle
- Push the power button to turn the system on

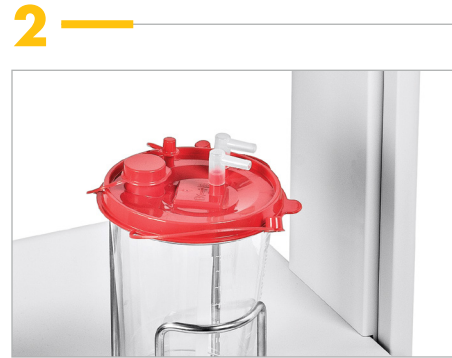

- Place the suction canister on the cart and install the right-angle elbow connectors to the port of the suction canister lid



- Insert the foot pedal cable connector, or wireless dongle if using wireless pedal, into the console foot pedal port
- The port will turn from white to green when the foot pedal is connected

(See separate section for wireless foot pedal setup)



- Pass the sterilization tray, containing the handpiece and torque wrench, onto the sterile field
- The tray does not need to stay on the sterile field, only the torque wrench



- Pass the connector end of the handpiece cable out of the sterile field and connect to the console
- The handpiece port ring will blink green before a tip and sleeve is installed and solid green after it is installed



- Peel the outer packaging of the suction tubing and transfer the inner package onto the sterile field
- Retain the black plastic cleaning wire for use in case of clogged tip
- Remove and dispose the twist tie and paper holders
- Repeat this process with the tip and sleeve

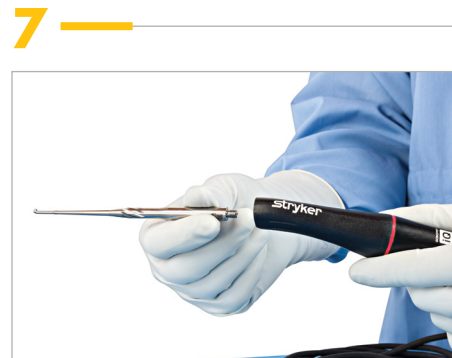

- Manually thread the tip onto the handpiece until it is finger tight
- Next you will place the torque wrench into the tip notches with the arrow facing the distal end of the tip
- Grip the torque wrench near the end of the handle. If your hand is placed 40mm – 45mm away like the image below you are more likely to apply the proper amount of torque that is needed.

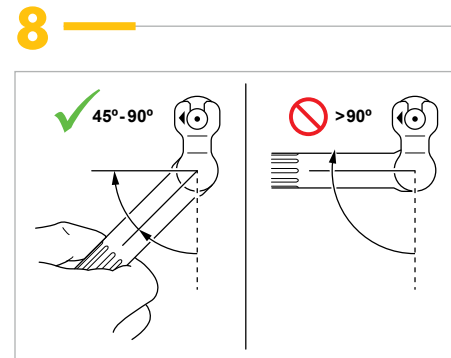

- The Sonopet iQ tip is sufficiently torqued when the torque wrench has rotated between 45 and 90 degrees as shown in the image below. For consistent results it is recommended to always rotate the torque wrench to 90 degrees. Make sure you do not go beyond 90 degrees as this could lead to over torquing. If torqued on less than 45 degrees this could result in under torquing.

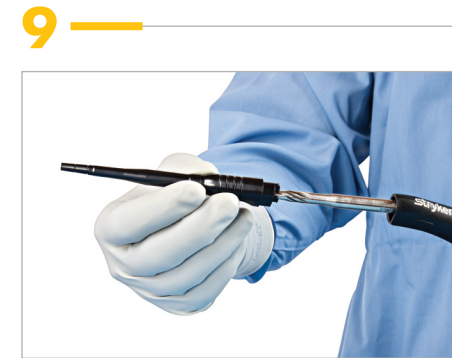

- Slide the tip sleeve over the tip and onto the handpiece until the sleeve clicks into place



- Attach the black tubing connector onto the base of the handpiece

Setup

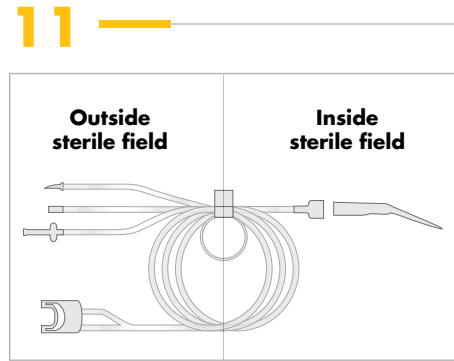

- Pass the tubing bundle with the cassette, irrigation spike and suction canister tubing off the sterile field towards the console



- Insert the cassette with the arrow pointing up into the console receptacle until an audible click is heard
- The cassette icon will turn green



- Attach the suction tube marked "vacuum" to the suction canister port marked "vacuum"
- Attach the suction tube marked 'patient' to the suction canister port marked 'patient'

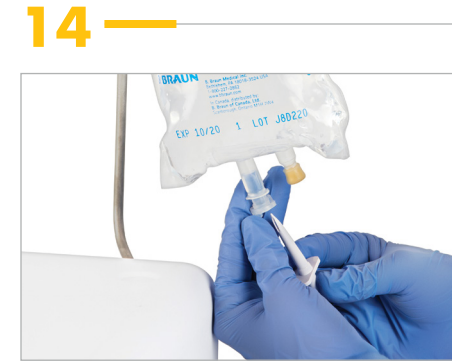

- Remove the protective plug from the irrigation spike and insert into the irrigation bag



- From the system setup screen, touch the "initial prime button"
- Irrigation prime will stop once fluid reaches the tip
- A digital setup guide is available during setup by clicking the "?"

Setup

Optional hand controller

- Enables remote control of ultrasonic power, suction, irrigation flow rate and flush from the sterile field
- Using the alignment dots, insert hand controller cable into console receptacle
- Aseptically transfer the closed sterile drape into the sterile field; then open drape
- Pass hand controller into the sterile field and place into sterile drape
- Close drape cover



Setup questions?

Your console provides step-by-step, onscreen visual guides for system setup. Once power is applied, it will walk you through these screens until all required components are properly connected.

Or, to review these directions at any time, touch Settings from the System Setup or Home screens and then touch Handpiece Tip Setup and/or Cassette Tubing Setup.

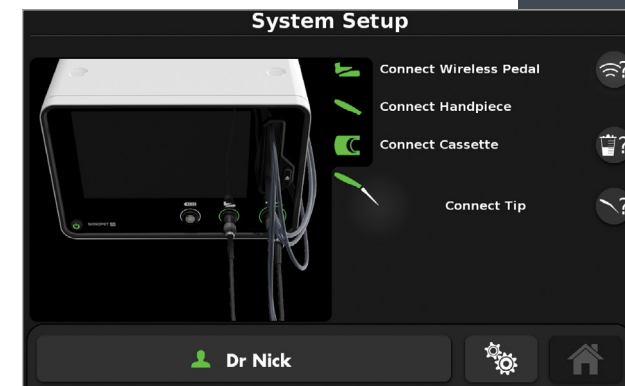
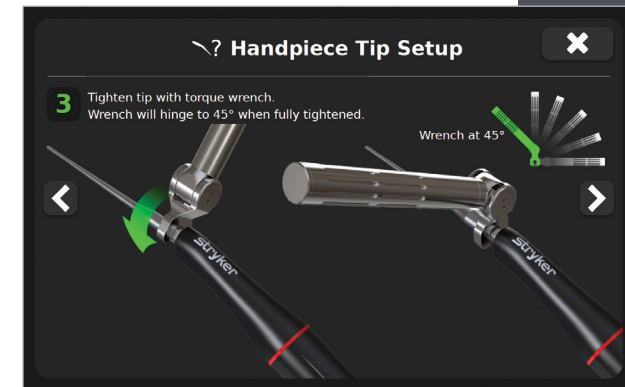

Wireless foot control for **flexibility**

The Sonopet iQ wireless foot pedal setup is easy and only takes two AA alkaline batteries with an expected 100 hour run time.

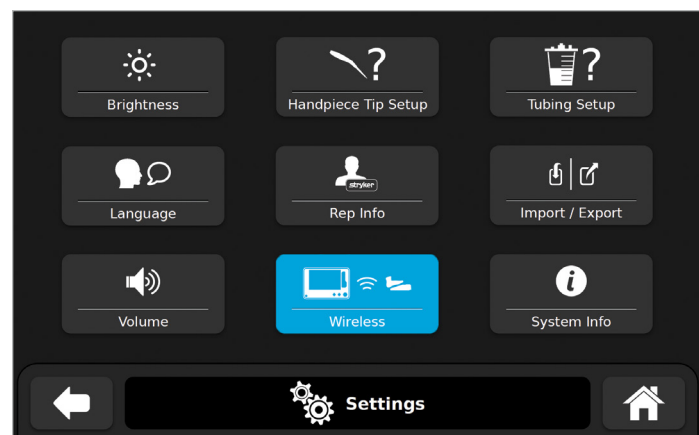

1

- Make sure the wireless foot pedal is less than two meters (six feet) from the console during wireless connection
- Plug the wireless receiver into the foot pedal port on the console
- Make sure the wireless foot pedal is On and the foot pedal indicator lamps are illuminated

2

- On system settings screen or wireless connection screen, touch the "Wireless" button

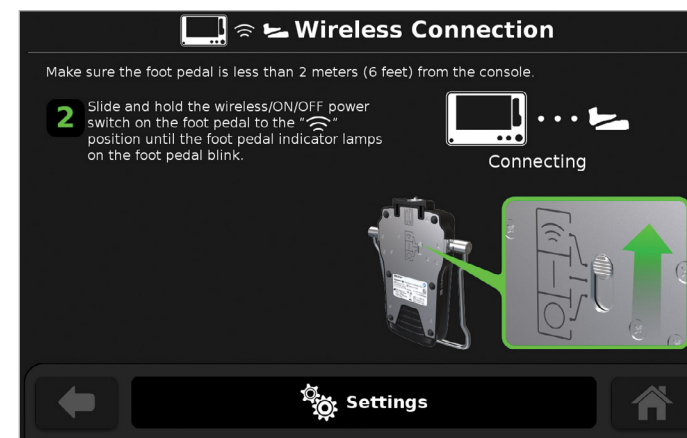

3

- From the "Wireless Connection" screen, touch the Pair Wireless button

4

- Slide and hold the "Wireless/On/Off" power switch on the foot pedal to the "Pair Wireless" position until the indicator lamps on the foot pedal blink
- Release the Wireless/On/Off power switch
- The foot pedal indicator lamps will stop blinking to indicate a successful pairing

5

- A green console port indicator confirms a successful connection
- An amber console port ring indicator signifies an error
- Low battery power (10 hours remaining) will also cause an error message
- After a successful connection, the wireless foot pedal can be used up to 4.6m (15 feet) of the console

performance

A class of its own

The Sonopet System is a market leader, and Sonopet iQ delivers even more of what our customers love. We've raised simplicity and reliability to an even higher level for consistently excellent O.R. surgical experiences. We've also added semi-autonomous functionality and unparalleled customization so you can do more with the Sonopet iQ with less time and effort.

Trusted resection and power

367%
faster fibrous
tissue resection¹

133%
faster bone
cutting¹

75%
more precise
suction control²

48%
faster setup time¹

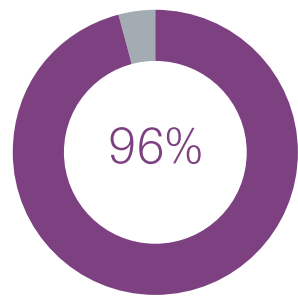

setup success rate
on first attempt by
untrained users¹

"Sonopet iQ is amazing. This changes neurosurgery, and provides confidence when resecting bone from the most critical areas"⁴

Neurosurgeon
Current Sonopet user

"If the equipment is not easy to set up, it won't be used. You guys really figured this out, when can we use this?"⁴

O.R. Nurse

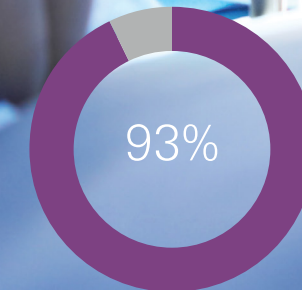

of ACGME facilities
rely on Sonopet³

"Sonopet has changed my whole business. And the new system looks even better."⁴

Neurosurgeon
Current Sonopet user

Product overview

Equipment overview

Soft tissue and bone cutting tips

System setup

Wireless foot pedal setup

Performance

Level setting

This guide summarizes some of the common features, functions, button pushing and menus of the Sonopet iQ Ultrasonic Surgical Aspirator and its system components.

The system is intended to help you:

- During surgical procedures, including neuro, gastrointestinal and affiliated organ, urological, plastic and reconstructive, general, orthopaedic, gynecological and thoracic
- Fragment, emulsify and aspirate (suction) soft tissue, hard/fibrous tissue and bone using a hand piece with a vibrating tip

Not for use on uterine fibroids. Use only with Stryker-approved components and accessories, and maintain proper field placement of sterile and non-sterile system components. Take special precaution regarding electromagnetic  compatibility, such as not putting equipment on top of or next to the console. Standard fire/heat safety tips apply, such as ensuring optimal irrigation flow

to in-use hand piece tips if frangible sections have been removed, and not using the system in areas where flammable anesthetics or agents are mixed with air, oxygen or nitrous oxide.

For a complete list of warnings and cautions, operational details, troubleshooting tips, cleaning protocols and duty cycles, please consult the Stryker Sonopet  iQ Instructions for Use (IFU Ref 5500-050-700), and Stryker IFUs for the corresponding torque wrench, hand pieces, hand controller, foot pedals, tips/sleeves, irrigation cassette and other accessories that connect to the Sonopet iQ aspiration system.

This user guide does not recommend surgical procedure or technique, and is not intended to replace Instructions for Use documents. It is purely provided to summarize commonly used features.

1. All comparative metrics and claims are Sonopet iQ compared to Sonopet 1. Stryker internal test data on file
2. Sonopet iQ has improved suction control for delicate resection rates with 75% lower achievable pressure settings compared to the first generation Sonopet. Stryker internal data.
3. The Sonopet Ultrasonic Aspirator is currently being used in 104 out of 112 ACGME teaching institutions in the U.S. Stryker internal data on file.
4. Source and consent on file

Neurosurgical

This document is intended solely for the use of healthcare professionals. A surgeon must always rely on his or her own professional clinical judgment when deciding whether to use a particular product when treating a particular patient. We do not dispense medical advice and recommend that surgeons be trained in the use of any particular product before using it in surgery.

The information presented is intended to demonstrate Stryker's products. A surgeon must always refer to the package insert, product label and/or instructions for use, including the instructions for cleaning and sterilization (if applicable), before using any of Stryker's products. Products may not be available in all markets because product availability is subject to the regulatory and/or medical practices in individual markets. Please contact your representative if you have questions about the availability of Stryker's products in your area.

Stryker or its affiliated entities own, use, or have applied for the following trademarks or service marks: Apex, Barracuda, Sonopet iQ and Stryker. All other trademarks are trademarks of their respective owners or holders

Stryker
4100 East Milham Avenue
Kalamazoo, MI 49001 USA
t: 269 323 7700 f: 269 323 2742
toll free: 800 253 3210

neurosurgical.stryker.com